

Sinclair  Hammelton

ASKING PRICE

**£1,500,000**

**Plot 2 Baston Road**

Hayes, BR2 7BS

EPC RATING: COUNCIL TAX BAND: NEW BUILD

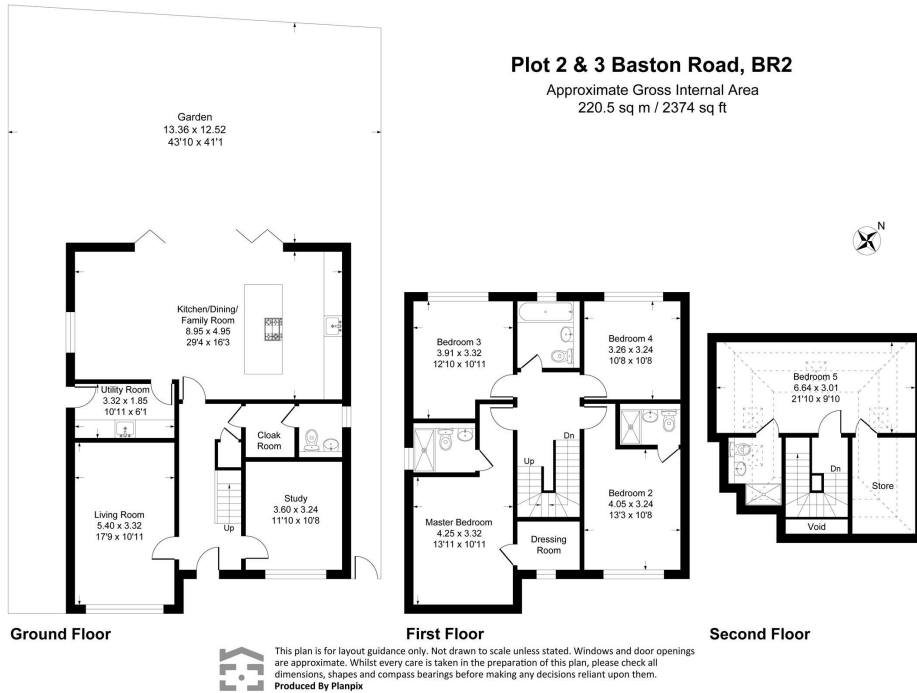

| Energy Efficiency Rating                           |          | Current                    | Potential |
|--|----------|----------------------------|-----------|
| <i>Very energy efficient - lower running costs</i> |          |                            |           |
| (92 plus)  | <b>A</b> |                            |           |
| (81-91)  | <b>B</b> |                            |           |
| (69-80)  | <b>C</b> |                            |           |
| (55-68)  | <b>D</b> |                            |           |
| (39-54)  | <b>E</b> |                            |           |
| (21-38)  | <b>F</b> |                            |           |
| (1-20)   | <b>G</b> |                            |           |
| <i>Not energy efficient - higher running costs</i> |          |                            |           |
| <b>England &amp; Wales</b>                         |          | EU Directive<br>2002/91/EC |           |

Agents Note: Whilst every care has been taken to prepare these particulars, they are for guidance purposes only. All measurements are approximate and are for general guidance purposes only and whilst every care has been taken to ensure their accuracy, they should not be relied upon and potential buyers/tenants are advised to recheck the measurements



**OFFICE ADDRESS**

3a Station Approach  
Hayes  
Kent  
BR2 7EQ

**OFFICE DETAILS**

020 8462 0360  
infohy@sinclairhammelton.co.uk